



17 Ashlea

Thurnscoe, Rotherham, S63 0GY

Offers Over £110,000



Nestled in the charming area of Thurnscoe, Rotherham, this delightful townhouse presents an excellent opportunity for those seeking a comfortable and modern living space. Built between 2000 and 2009, the property boasts a contemporary design that is both practical and inviting.

Upon entering, you will find a well-proportioned reception room that serves as a perfect space for relaxation or entertaining guests. The property features two spacious double bedrooms, providing ample room for rest and personalisation. The shower room is thoughtfully designed, complemented by an additional W/C for convenience, making it ideal for families.

The kitchen is equipped with sufficient storage and offers space for a small table, creating a cosy dining area where you can enjoy meals with family or friends. The layout of the home ensures a seamless flow between the living spaces, enhancing the overall sense of comfort.

Outside, the property benefits from parking for one vehicle at the front, ensuring ease of access. The rear garden offers a private outdoor space, perfect for enjoying the fresh air or tending to a small garden.



Area Map



Floor Plans

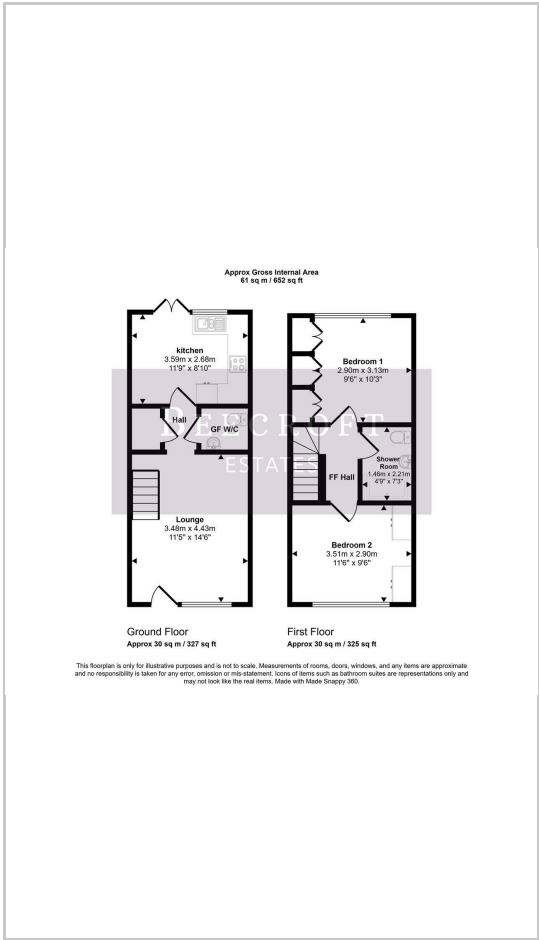

Energy Efficiency Graph

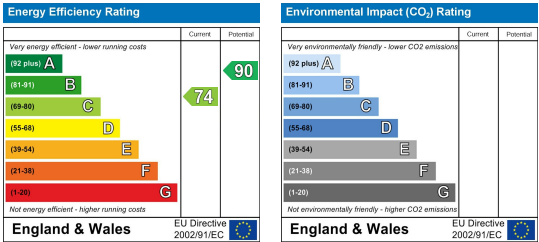

These particulars, whilst believed to be accurate are set out as a general outline only for guidance and do not constitute any part of an offer or contract. Intending purchasers should not rely on them as statements of representation of fact, but must satisfy themselves by inspection or otherwise as to their accuracy. No person in this firms employment has the authority to make or give any representation or warranty in respect of the property.