



10 Wheata Drive

, Sheffield, S5 9FJ

£150,000



Three-Bedroom Semi-Detached Home in Sheffield – Great Project Opportunity

This spacious three-bedroom semi-detached home, located in Sheffield, offers fantastic potential and would make an ideal family home. Requiring modernisation throughout, it presents a great opportunity for buyers looking to put their own stamp on a property.

The accommodation offers generous living space, including a downstairs WC, and three well-proportioned bedrooms.

Externally, the property benefits from off-road parking via a driveway, along with both front and rear gardens, providing excellent outdoor space.

Conveniently located close to local amenities, this property is perfectly positioned for everyday living. Early viewing is recommended to appreciate the potential on offer.



GROUND FLOOR
 ENTRANCE HALL
 LOUNGE
 DINING KITCHEN
 DOWNSTAIRS WC
 FIRST FLOOR
 LANDING
 BEDROOM ONE
 BEDROOM TWO
 BEDROOM THREE
 BATHROOM
 OUTSIDE

Area Map

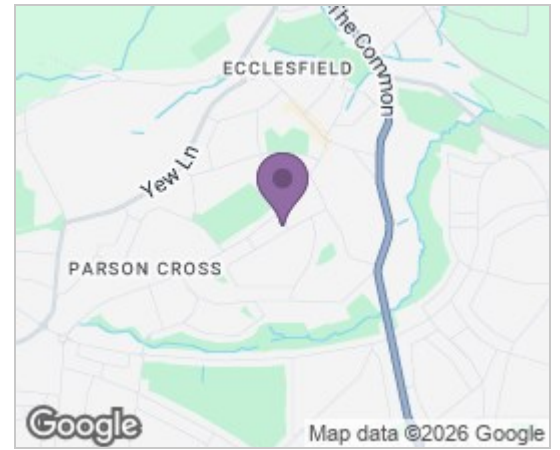

Floor Plans

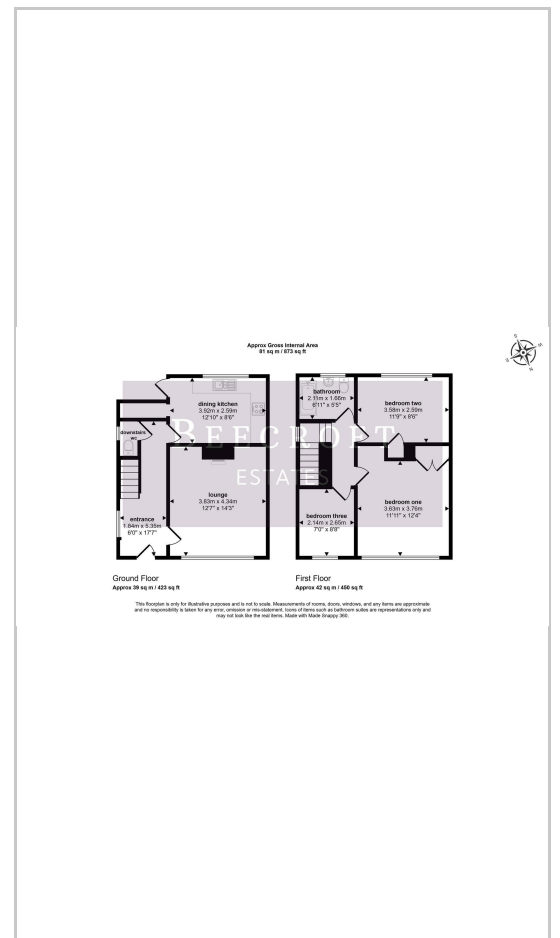

Energy Efficiency Graph

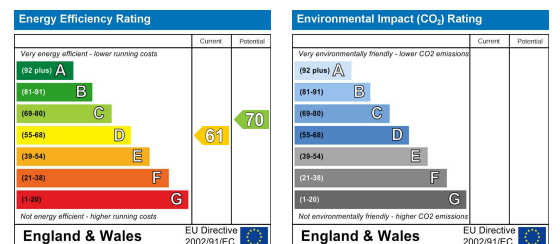

These particulars, whilst believed to be accurate are set out as a general outline only for guidance and do not constitute any part of an offer or contract. Intending purchasers should not rely on them as statements of representation of fact, but must satisfy themselves by inspection or otherwise as to their accuracy. No person in this firm's employment has the authority to make or give any representation or warranty in respect of the property.