



7 Grange Court

Wombwell, Barnsley, S73 0EZ

£95,000



A well-presented two-bedroom first-floor apartment, offering spacious open-plan living and kitchen space, a master bedroom with en-suite, and a second bedroom ideal for guests or home working.

The apartment is set within beautifully maintained grounds, featuring ample grassed areas and mature trees, creating a peaceful and attractive setting.



Area Map



Floor Plans

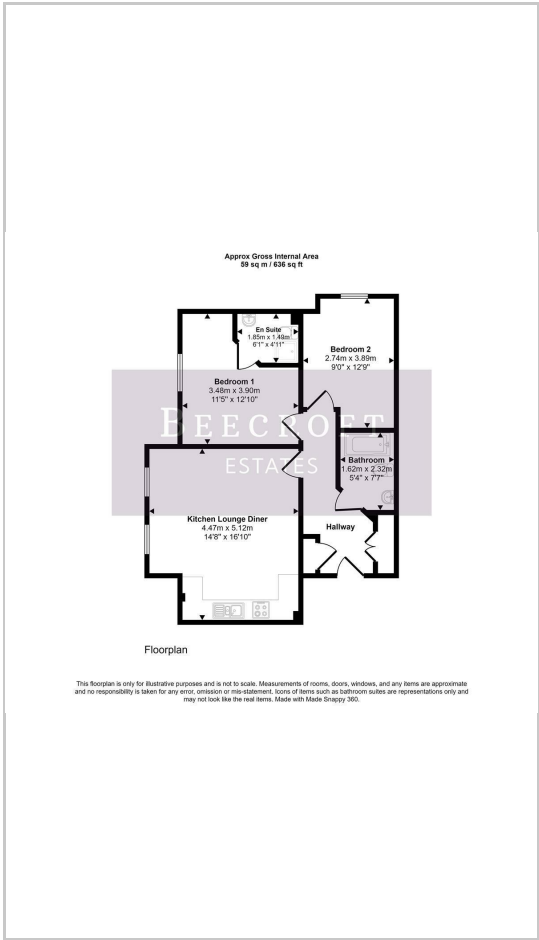

Energy Efficiency Graph

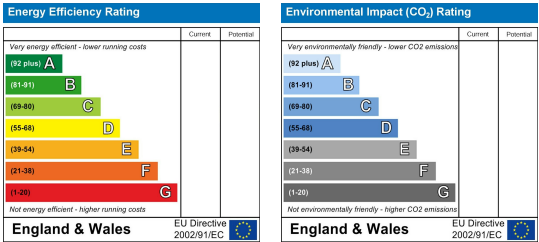

These particulars, whilst believed to be accurate are set out as a general outline only for guidance and do not constitute any part of an offer or contract. Intending purchasers should not rely on them as statements of representation of fact, but must satisfy themselves by inspection or otherwise as to their accuracy. No person in this firms employment has the authority to make or give any representation or warranty in respect of the property.

Wombwell 6-8 Park Street, Wombwell, S73 0DJ
Tel: 01226 340110 Email: info@beecroftestates.co.uk www.beecroftestates.co.uk