



79 Meadowhall Road

, Rotherham, S61 2JD

£105,000



Situated in this sought after residential area, the property is stones throw from junction 34 of the M1, Meadowhall and Sheffield. The surrounding area also has schools and amenities at your convenience giving any property in this area huge appeal to potential tenants. On the market with NO CHAIN this property would make the perfect INVESTMENT purchase with generous return yields or even a great first time buy. Viewings advised to avoid disappointment.



GROUND FLOOR

LOUNGE

Located at the front of the property is a neutrally decorated lounge area, upvc double glazed window, radiator and additional wall hung fire.

DINING ROOM

A spacious dining area which has a rear facing double glazed window, radiator, feature fireplace and door leading to the stairs.

KITCHEN

A range of wall and base units worktop surface over which incorporates the sink with mixer tap, space for appliances, side entrance door and rear facing double glazed window.

CELLAR

FIRST FLOOR

BEDROOM ONE

A double bedroom having a storage cupboard, front facing double glazed window and radiator.

BEDROOM TWO

A rear facing bedroom having a double glazed window and radiator.

BATHROOM

A three piece suite, double glazed window with obscure glazing and radiator.

SECOND FLOOR

ATTIC BEDROOM THREE

A double bedroom with a Velux style window, storage and radiator.

OUTSIDE

Front small forecourt and a rear yard.

Area Map



Floor Plans

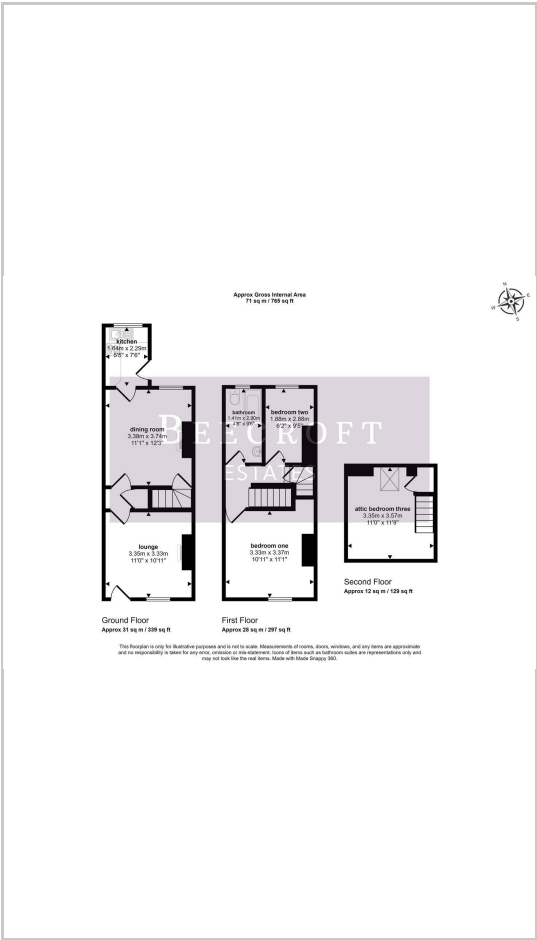

Energy Efficiency Graph

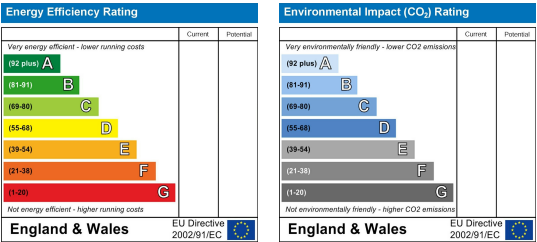

These particulars, whilst believed to be accurate are set out as a general outline only for guidance and do not constitute any part of an offer or contract. Intending purchasers should not rely on them as statements of representation of fact, but must satisfy themselves by inspection or otherwise as to their accuracy. No person in this firms employment has the authority to make or give any representation or warranty in respect of the property.