



27 Brierley Road

Shafton, Barnsley, S72 8QQ

Offers In The Region Of £124,000



This well-presented and spacious three-bedroom mid-terrace home is ideally located in Shafton, Barnsley. Situated close to local amenities, the property is offered with no upper chain and benefits from a rear garden, three generously sized bedrooms, a dining kitchen, a front-facing lounge, and a family bathroom to the first floor.

Ideally suited to first-time buyers or small families, this home offers excellent value at an affordable price.

CALL BEECROFT ESTATES TO BOOK YOUR VIEWING !



- GROUND FLOOR
- LOUNGE
- DINING KITCHEN
- CONSERVATORY
- FIRST FLOOR
- BEDROOM ONE
- BEDROOM TWO
- BATHROOM
- SECOND FLOOR
- ATTIC BEDROOM THREE
- OUTSIDE

Area Map



Floor Plans

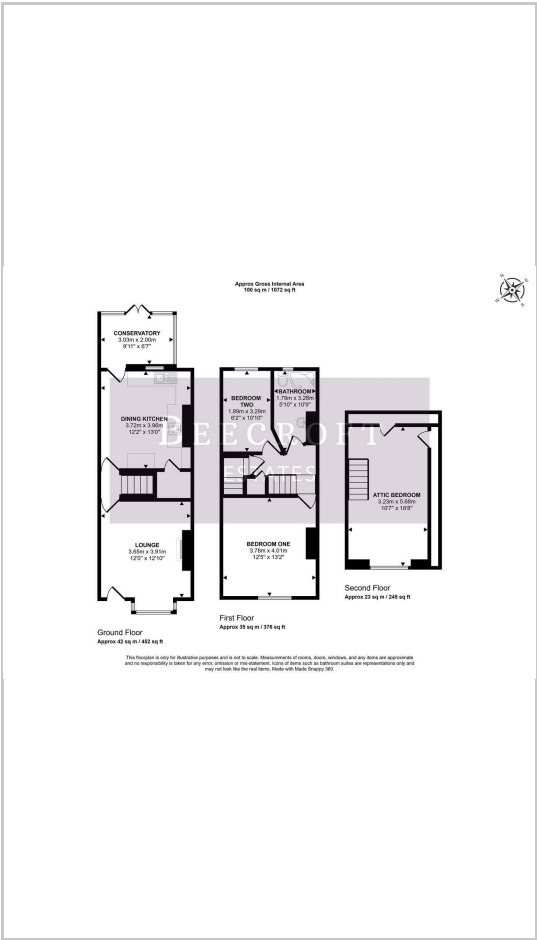

Energy Efficiency Graph



These particulars, whilst believed to be accurate are set out as a general outline only for guidance and do not constitute any part of an offer or contract. Intending purchasers should not rely on them as statements of representation of fact, but must satisfy themselves by inspection or otherwise as to their accuracy. No person in this firms employment has the authority to make or give any representation or warranty in respect of the property.