



6 St. Lukes Road

Grimethorpe, Barnsley, S72 7FN

£140,000



Ideal Starter Home or Downsizing Opportunity – Popular Location with Great Transport Links

Situated in a popular residential location, close to the Dearne Valley Parkway network, this well-positioned two-bedroom townhouse is ideal for those looking to commute daily.

The property offers two double bedrooms, off-road parking, and a rear garden, making it perfectly suited to first-time buyers or those looking to downsize.



GROUND FLOOR

ENTRANCE HALL

A welcoming entrance hall with stairs rising to the first-floor landing, creating a warm and inviting first impression.

LOUNGE

A spacious and bright lounge featuring two sets of French-style doors that open onto the rear garden, a generous storage cupboard, and a central heating radiator.

DINING KITCHEN

A modern kitchen fitted with a range of wall and base units and worktop surfaces incorporating a sink unit with mixer tap. Integrated appliances include a fridge freezer, oven, hob, extractor fan, washing machine, and dishwasher. A front-facing double-glazed window provides natural light, and there is a radiator and ample space for a dining table, making it a functional and sociable area.

DOWNSTAIRS WC

Comprising a WC and wash hand basin, with a radiator and a double-glazed window with obscure glass for privacy.

FIRST FLOOR

BEDROOM ONE

A double bedroom featuring two front-facing double-glazed windows, a radiator, and fitted storage, providing plenty of natural light and practical space.

BEDROOM TWO

A further double bedroom with a rear-facing double-glazed window and radiator.

BATHROOM

A three-piece bathroom suite comprising a bath with shower over, WC, and wash hand basin, complete with a radiator.

OUTSIDE

The front of the property features a buffer-style garden, while the rear garden is enclosed and mainly laid to lawn, offering a secure and low-maintenance outdoor space.

Area Map



Floor Plans

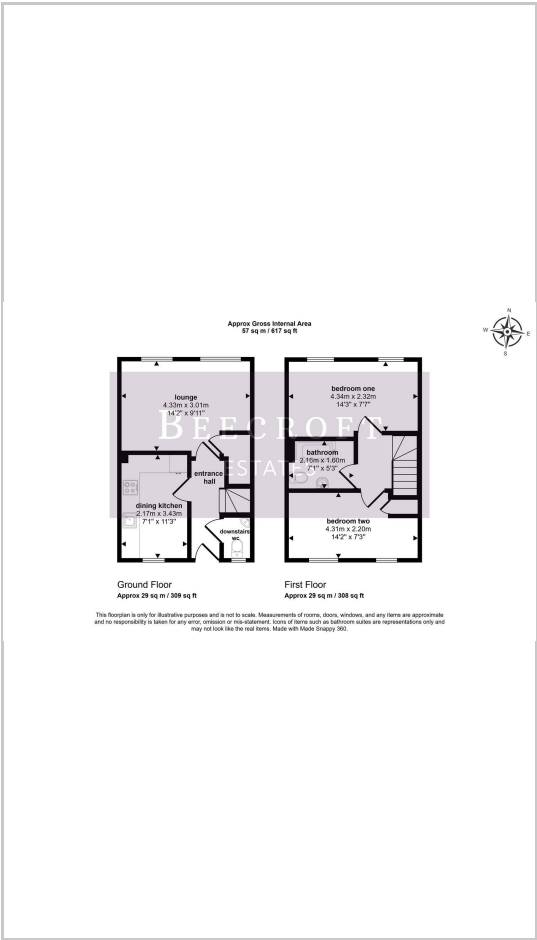

Energy Efficiency Graph

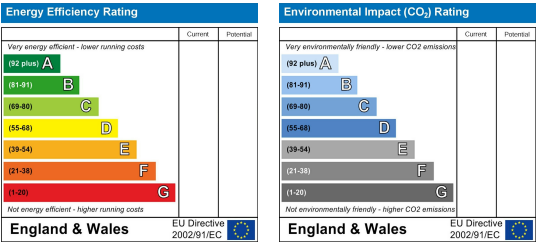

These particulars, whilst believed to be accurate are set out as a general outline only for guidance and do not constitute any part of an offer or contract. Intending purchasers should not rely on them as statements of representation of fact, but must satisfy themselves by inspection or otherwise as to their accuracy. No person in this firms employment has the authority to make or give any representation or warranty in respect of the property.