



60 Princess Road

, Mexborough, S64 0AW

£100,000



A two-bedroom mid-terrace home offering excellent potential for buyers looking to add their own stamp, available with no upper vendor chain. The property benefits from high ceilings and spacious rooms throughout, creating a light and airy feel.

To the first floor are two double bedrooms, with the principal bedroom featuring a walk-in wardrobe with potential to convert into an en-suite, along with a family bathroom.

To the ground floor, the accommodation comprises a front-facing lounge and a dining kitchen to the rear, with access to a useful cellar for additional storage.

Externally, there is a decent-sized rear garden, and the property is conveniently located within walking distance of local amenities.

This property presents an excellent opportunity for first-time buyers, investors, or those looking for a project.



GROUND FLOOR
 ENTRANCE
 LOUNGE
 DINING KITCHEN
 CELLAR
 FIRST FLOOR
 BEDROOM ONE
 BEDROOM TWO
 BATHROOM
 OUTSIDE

Area Map



Floor Plans

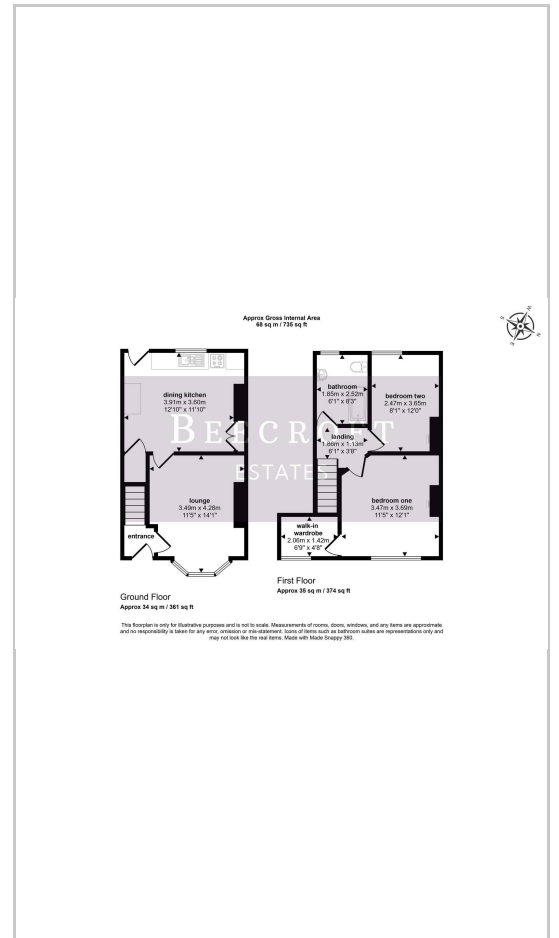

Energy Efficiency Graph



These particulars, whilst believed to be accurate are set out as a general outline only for guidance and do not constitute any part of an offer or contract. Intending purchasers should not rely on them as statements of representation of fact, but must satisfy themselves by inspection or otherwise as to their accuracy. No person in this firm's employment has the authority to make or give any representation or warranty in respect of the property.