



10 Lundhill View

Wombwell, Barnsley, S73 0ZA

Offers Over £170,000



Modern 2-Bedroom Townhouse - Perfect for First-Time Buyers or Investors!!

Be quick to view this this fantastic 2-bedroom townhouse which is ready to move straight into. Located on a modern development just 4 years old, in the popular area of Wombwell, the property benefits from excellent local amenities, good transport links, and nearby schools – making it ideal for a range of buyers.

Well-maintained throughout, this home would be a great choice for first-time buyers or a smart opportunity for investors, with strong rental demand and a healthy return.

Don't miss out – properties in this area don't stay available for long!



Entrance Hall

Welcoming entrance hall offering access to the cloakroom and stairs leading to the first floor.

Cloakroom

A well-appointed cloakroom featuring a modern white suite comprising a pedestal wash hand basin and low flush WC. Finished in neutral décor with an obscure glazed window providing natural light and privacy.

Lounge

Relax in this inviting front-aspect lounge, tastefully finished in neutral décor. The room also benefits from access to a useful built-in storage cupboard, ideal for keeping everyday essentials neatly tucked away.

Kitchen/Diner

A stylish modern kitchen/diner featuring a range of gloss-finished wall and base units, complemented by a stainless steel electric oven and matching extractor fan. There's ample space for a fridge/freezer, along with plumbing for both a washing machine and dishwasher—ideal for contemporary family living.

Master Bedroom

A generously sized rear-aspect master bedroom, tastefully finished in neutral décor. The room offers ample space for either freestanding or fitted furniture, allowing flexibility to suit your needs.

Bedroom Two

A bright and spacious double bedroom featuring a dual front-aspect, allowing plenty of natural light. The room offers ample space for you to install your own storage solutions, making it a versatile and functional space.

Bathroom

A modern bathroom suite comprising a panelled bath with electric shower and glass shower screen, a low flush WC, and a pedestal wash hand basin. Finished in a clean, contemporary style—ideal for everyday comfort and convenience.

Exterior

To the front of the property, a driveway provides convenient off-road parking. To the rear, you'll find a good-sized enclosed garden, mainly laid to lawn with a flagged patio area. perfect for outdoor dining, relaxing, or entertaining.

Area Map



Floor Plans

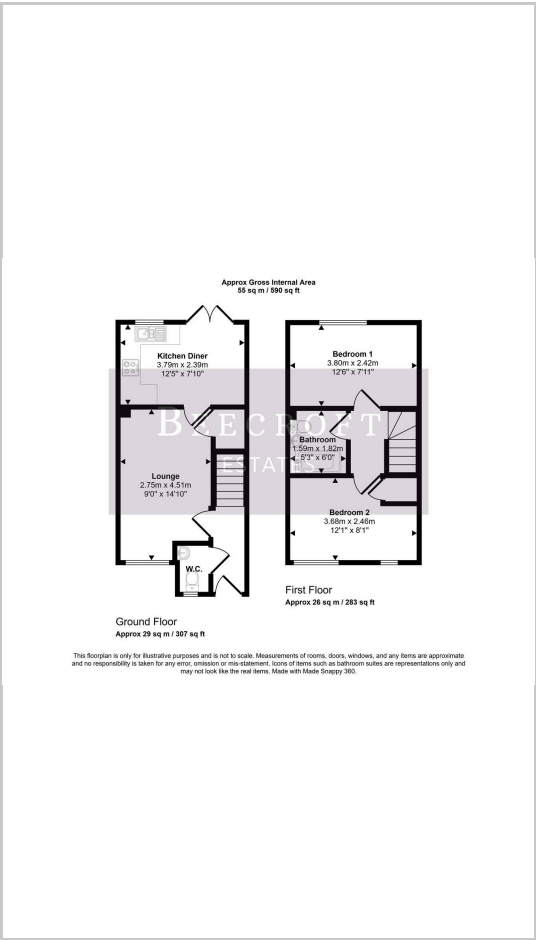

Energy Efficiency Graph

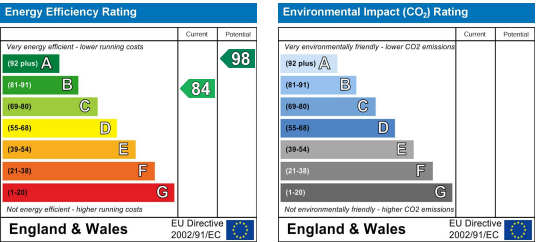

These particulars, whilst believed to be accurate are set out as a general outline only for guidance and do not constitute any part of an offer or contract. Intending purchasers should not rely on them as statements of representation of fact, but must satisfy themselves by inspection or otherwise as to their accuracy. No person in this firms employment has the authority to make or give any representation or warranty in respect of the property.