



## 30 Dove Road

Wombwell, Barnsley, S73 0TE

£210,000



Spacious 3-Bedroom Semi-Detached in Wombwell – No Upper Vendor Chain

Located on a popular estate in Wombwell, this deceptively spacious three-bedroom semi-detached home offers excellent living space and great potential for a variety of buyers.

Key features include:

Conservatory extension providing additional living space

Driveway for off-road parking



- GROUND FLOOR
- ENTRANCE
- LOUNGE
- DINING KITCHEN
- FIRST FLOOR
- BEDROOM ONE
- BEDROOM TWO
- BEDROOM THREE
- BATHROOM
- OUTSIDE

Area Map

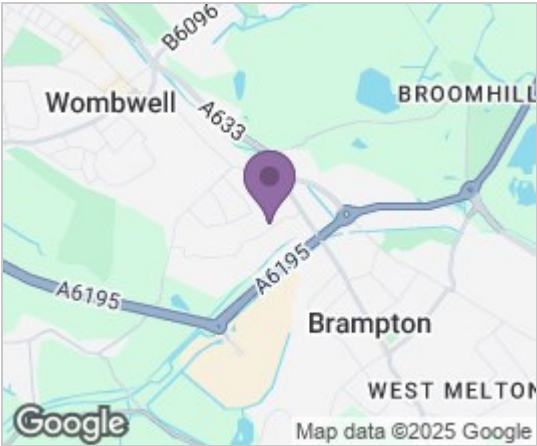

Floor Plans

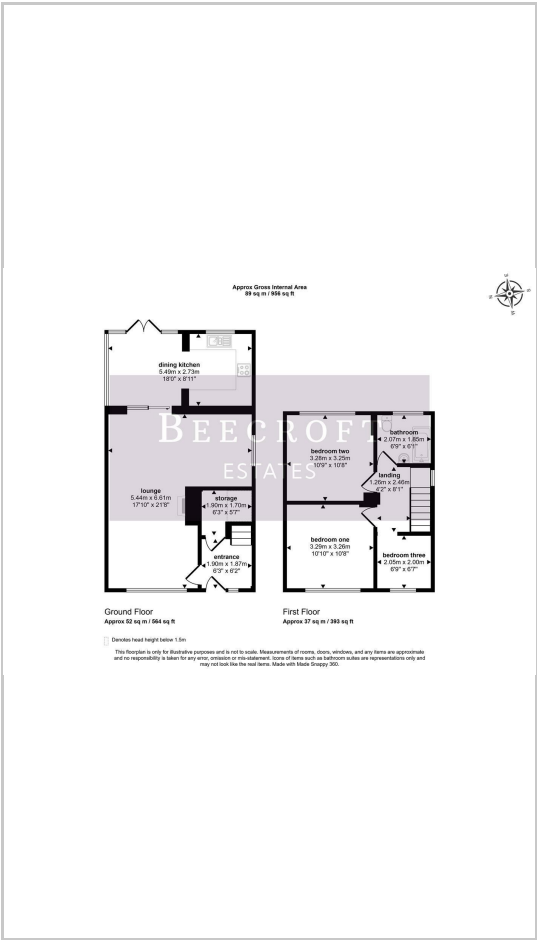

Energy Efficiency Graph



These particulars, whilst believed to be accurate are set out as a general outline only for guidance and do not constitute any part of an offer or contract. Intending purchasers should not rely on them as statements of representation of fact, but must satisfy themselves by inspection or otherwise as to their accuracy. No person in this firms employment has the authority to make or give any representation or warranty in respect of the property.