



16 Mayflower Way

Wombwell, BARNSELY, S73 0AJ

£98,500



NO UPPER VENDOR CHAIN

Spacious ground floor apartment situated within the popular Mayflower development, benefiting from allocated parking and additional visitor parking. This apartment is move-in ready and would be ideally suited to a first-time buyer, downsizer, elderly couple, or indeed an investor, with a potential rental income of approximately £700 PCM. Conveniently located close to local amenities, transport links, and the train station.



ENTRANCE

LOUNGE/KITCHEN/DINING

Spacious and bright, this open-plan living space offers integrated appliances within the kitchen area and ample space for furniture, with TV aerial points and various double-glazed windows providing plenty of natural light.

BEDROOM ONE

A double bedroom featuring a double-glazed window, with a door providing access to the en-suite.

EN-SUITE

A three-piece suite comprising a shower cubicle, WC, and wash hand basin.

BEDROOM TWO

A further double bedroom with a rear-facing double-glazed window.

BATHROOM

A modern three-piece suite comprising a bath with shower over, WC, and wash hand basin, partly tiled and featuring a window with obscure glazing.

OUTSIDE

There are communal areas and grounds, along with allocated parking and visitor parking.

Area Map



Floor Plans

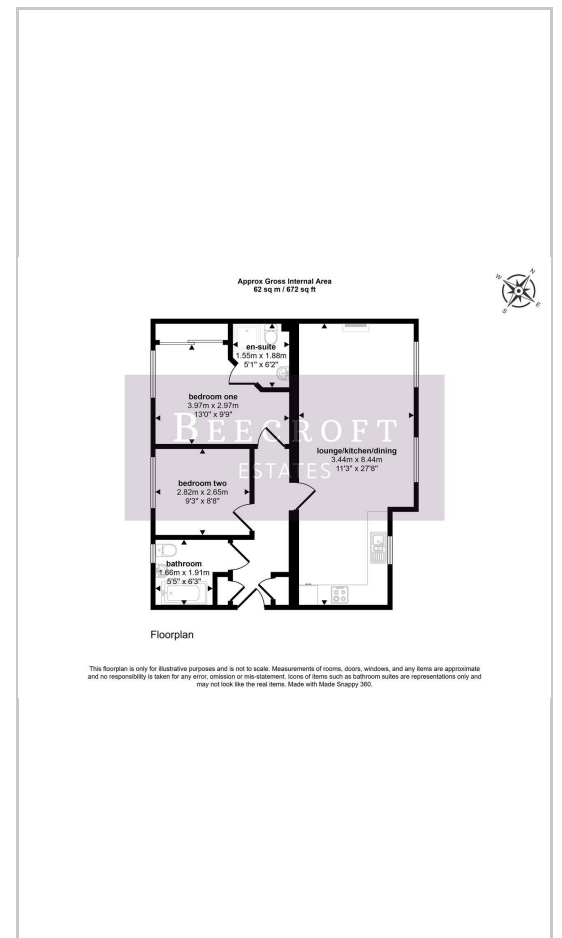

Energy Efficiency Graph

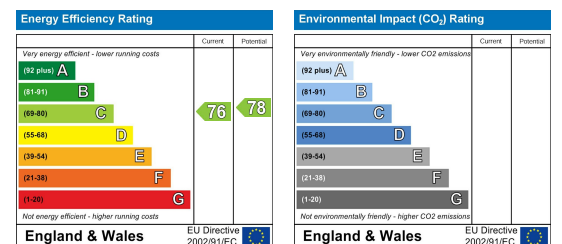

These particulars, whilst believed to be accurate are set out as a general outline only for guidance and do not constitute any part of an offer or contract. Intending purchasers should not rely on them as statements of representation of fact, but must satisfy themselves by inspection or otherwise as to their accuracy. No person in this firm's employment has the authority to make or give any representation or warranty in respect of the property.

Wombwell 6-8 Park Street, Wombwell, S73 0DJ

Tel: 01226 340110 Email: info@beecroftestates.co.uk www.beecroftestates.co.uk