



6 Kingwood Close

, Barnsley, S71 5SF

£135,000



Well-Presented Two Bedroom Townhouse – Ideal for First-Time Buyers or Downsizers

Located on a popular development in Monk Bretton, Barnsley, this modern two-bedroom townhouse offers a fantastic opportunity for first-time buyers or those looking to downsize.

The property is well maintained and ready to move straight into, boasting:

A spacious lounge

Modern kitchen



GROUND FLOOR
ENTRANCE HALL
LOUNGE
DINING KITCHEN
FIRST FLOOR
BEDROOM ONE
BEDROOM TWO
BATHROOM
OUTSIDE

Area Map



Floor Plans

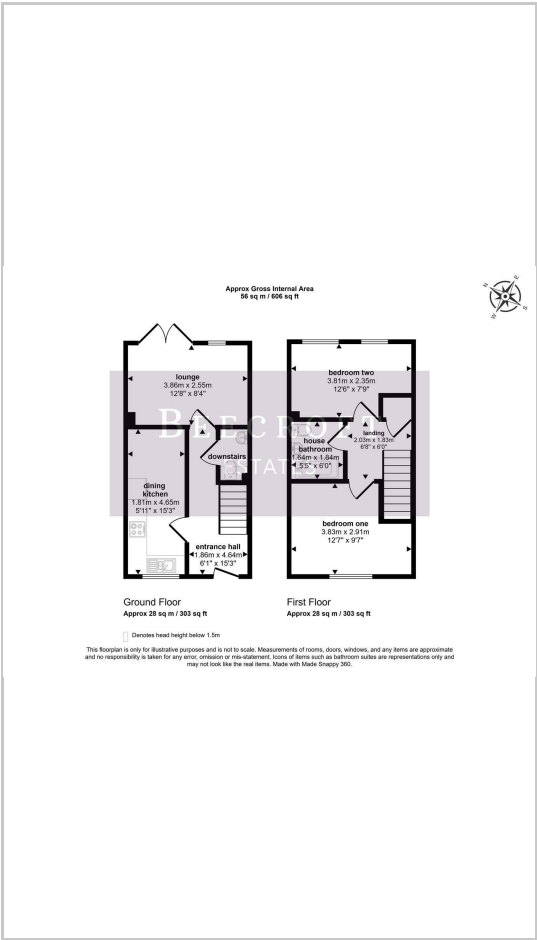

Energy Efficiency Graph

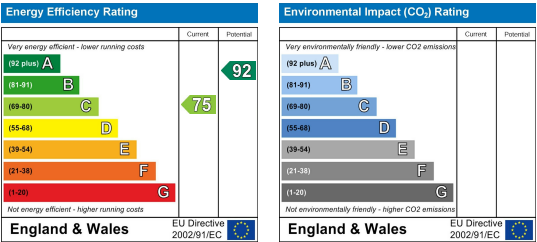

These particulars, whilst believed to be accurate are set out as a general outline only for guidance and do not constitute any part of an offer or contract. Intending purchasers should not rely on them as statements of representation of fact, but must satisfy themselves by inspection or otherwise as to their accuracy. No person in this firms employment has the authority to make or give any representation or warranty in respect of the property.