



32 Wheatcrofts

, Barnsley, S70 6BZ

£260,000



Discover Space, Style, and Versatility in This Four-Storey Home

Designed for those who crave room to grow and spaces that adapt to every lifestyle, this superb four-storey 4 bedroom property offers generous living throughout.

Step inside to find two spacious en-suite bedrooms, a sleek and modern kitchen-diner, and an expansive lounge that's perfect for entertaining or unwinding.

Outside, enjoy the large enclosed rear garden — a low-maintenance retreat, ideal for family fun, entertaining, or simply relaxing in the sun without the upkeep.

Located just a 10-minute walk from the vibrant town centre, you'll benefit from easy access to well-regarded schools, major road links, and beautiful countryside walks. This home is perfect for families and professionals alike, offering flexible living, a spacious, low-maintenance garden, and even additional land, providing ample outdoor space for play and relaxation.



GROUND FLOOR

Entrance Hall

Step into a welcoming entrance hallway that sets the tone for this spacious home. Neutrally decorated and well-maintained, the hallway offers access to the ground floor accommodation and features a staircase with a modern balustrade, rising to the first-floor landing.

Integral Garage/Storage

The integral garage has been thoughtfully divided into two sections: a versatile space to the front, ideal for a home office, gym, or storage, and a bike storage area to the rear, offering practical functionality without compromising on space.

Cloakroom

Conveniently located on the ground floor, the cloakroom WC and a pedestal wash hand basin.

Utility Room

A practical and functional space offering additional storage and workspace, the utility room features plumbing for a washing machine and space for a tumble dryer. Ideal for keeping laundry separate from the main living areas, this room helps maintain a tidy and organised home.

FIRST FLOOR

Kitchen/Diner

A generously sized and well-appointed kitchen diner, perfect for both everyday family life and entertaining. Featuring an extensive range of wood-finish wall, base units, and drawers, this space offers vast storage and a practical layout. The kitchen is equipped with a stainless steel electric oven, stainless steel extractor fan, and space for a fridge freezer. Natural light floods the room through French doors with glazed side panels, creating a bright and airy atmosphere while providing direct access to the rear garden — ideal for al fresco dining or summer gatherings.

Cloakroom

Conveniently located on the first floor, this cloakroom is easily accessible from both the kitchen and lounge areas. It features a WC and a pedestal wash hand basin, with a side aspect window providing natural light and ventilation — a practical addition for guests and everyday use.

Lounge

Relax and unwind in this inviting lounge, enhanced by a modern colour scheme that adds warmth and style. Dual front-facing windows flood the space with natural light, creating a bright and welcoming atmosphere. It's the perfect setting for family time, entertaining guests, or simply enjoying a quiet evening in comfort.

SECOND FLOOR

Master Bedroom

Spacious master bedroom with a front-facing aspect allowing natural light, decorated in a neutral colour scheme to create a calm and relaxing atmosphere. This room also boasts fitted wardrobes, providing ample storage and hanging space.

En-suite

The master bedroom is complemented by a stylish en-suite, fitted with a modern white suite comprising a vanity wash hand basin, a low flush WC, and a fully tiled shower cubicle with a thermostatic shower. Finished with contemporary white tiles, this en-suite offers both comfort and functionality.

Bedroom Two

The second front-facing bedroom is a good size single room, currently been used as a home office, this offers flexibility to suit a variety of needs. Whether used as a workspace, nursery, or guest room, the neutral décor and natural light make it a bright and practical space.

Family Bathroom

A neutral, modern bathroom featuring a white suite comprising a panelled bath, wash hand basin, and low flush WC.

THIRD FLOOR

Bedroom Three

Located on the third floor, this spacious double bedroom enjoys a rear-facing aspect and benefits from its own en-suite bathroom, offering privacy and comfort. Ideal as a guest suite, older child's room, or even a private retreat, this bedroom combines space, light, and convenience.

En-suite

Fitted with a modern white suite comprising a vanity wash hand basin, a low flush WC, and a fully tiled shower cubicle with a thermostatic shower. Finished with contemporary white tiles, this en-suite offers both comfort and functionality.

Bedroom Four

Located on the third floor, this well-proportioned single bedroom enjoys a front-facing aspect and benefits from its own private en-suite, comprising a modern suite with shower, wash hand basin, and low flush WC. Ideal for use as a guest room, teenager's space, or home office, this bright and versatile room offers both comfort and practicality.

Exterior

To the front of the property, a tarmac driveway provides off-road parking and leads to the integral garage, offering both convenience and additional storage.

To the rear, you'll find a low-maintenance, enclosed garden laid with stone flagging, ideal for outdoor seating and relaxation. The space is beautifully enhanced with decorative mature shrubs, adding a touch of greenery and character without the upkeep.

Area Map



Floor Plans

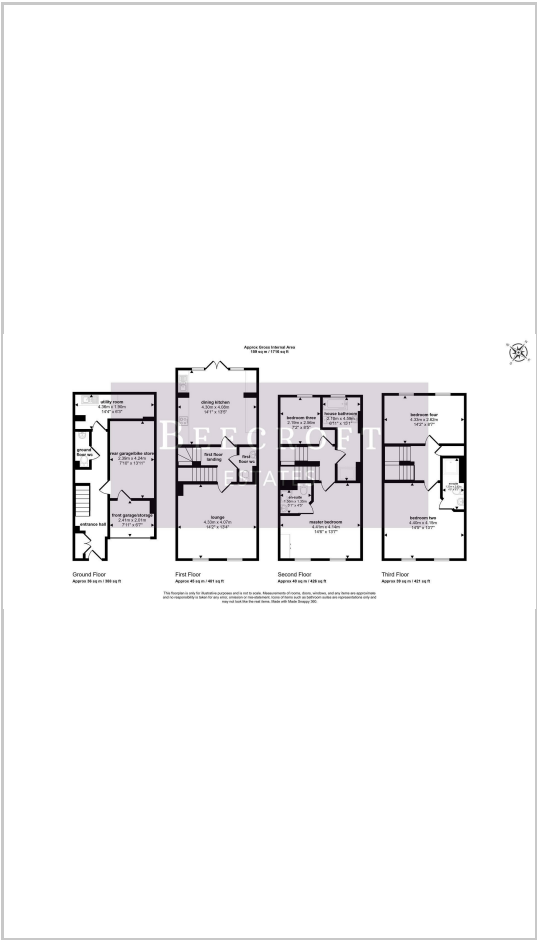

Energy Efficiency Graph

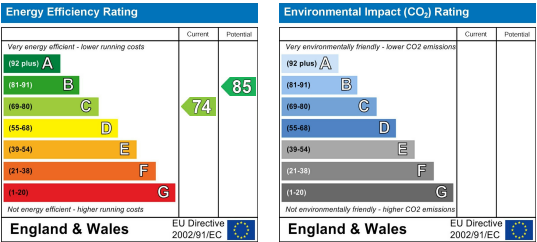

These particulars, whilst believed to be accurate are set out as a general outline only for guidance and do not constitute any part of an offer or contract. Intending purchasers should not rely on them as statements of representation of fact, but must satisfy themselves by inspection or otherwise as to their accuracy. No person in this firms employment has the authority to make or give any representation or warranty in respect of the property.