



8 Myrtle Road

Wombwell, Barnsley, S73 8LN

£99,950



Two-Bedroom End-Terrace with Driveway and Garden – Ideal Investment Opportunity

This two-bedroom end-terrace property offers fantastic potential and is ideal for investors. The accommodation includes a spacious lounge, separate dining room, and kitchen, along with a private rear garden and off-road parking via a driveway.

While the property would benefit from some modernisation, it is currently achieving a rental income of £675 PCM, making it a great buy-to-let opportunity.

Early viewing is recommended to appreciate the space and potential on offer.



- GROUND FLOOR
- LOUNGE
- DINING ROOM
- KITCHEN
- FIRST FLOOR
- BEDROOM ONE
- BEDROOM TWO
- BATHROOM
- OUTSIDE

Area Map



Floor Plans

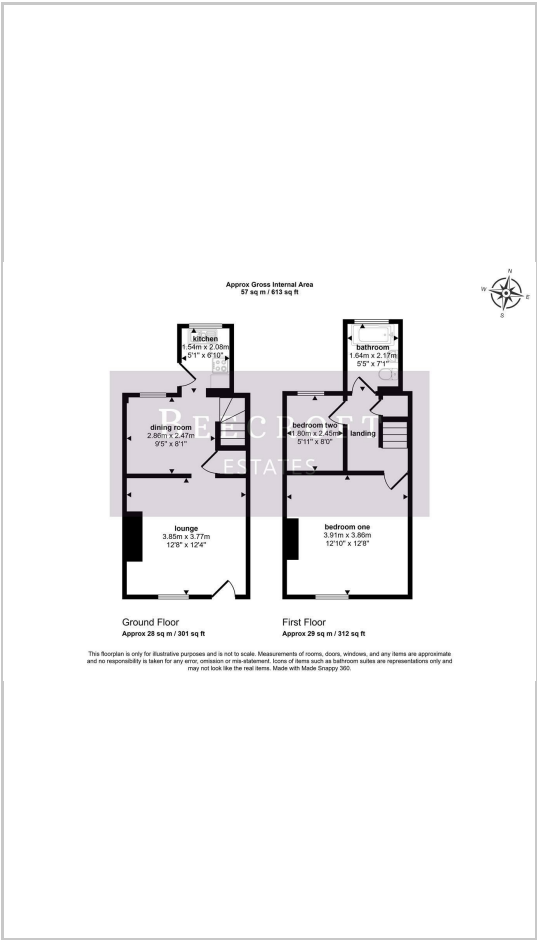

Energy Efficiency Graph



These particulars, whilst believed to be accurate are set out as a general outline only for guidance and do not constitute any part of an offer or contract. Intending purchasers should not rely on them as statements of representation of fact, but must satisfy themselves by inspection or otherwise as to their accuracy. No person in this firms employment has the authority to make or give any representation or warranty in respect of the property.