



71 The Walk

Birdwell, Barnsley, S70 5UB

£180,000



Stunning Stone-Fronted End-Terrace Cottage in the Heart of Birdwell

This beautifully presented cottage offers fantastic views and a charming rustic feel throughout. Situated in a sought-after location, it combines character, practicality, and modern comforts.

The property boasts:

Two garages and off-road parking to the rear

A low-maintenance garden with decked and patio seating areas.



GROUND FLOOR

ENTRANCE PORCH

A bright and welcoming space, featuring a composite door, two double-glazed windows, and stylish tiled flooring.

LOUNGE

A spacious lounge with a front-facing double-glazed window, central heating radiator, and TV aerial point—a comfortable space to relax and unwind.

DINING KITCHEN

A good-sized dining kitchen, comprising a range of solid wood wall and base units with complementary worktop surfaces incorporating a sink unit with mixer tap. Includes an integrated oven with hob and extractor, plumbing for a washing machine, and space for additional appliances.

There is also a generous under-stairs storage cupboard, a rear-facing double-glazed window overlooking the garden, and a door leading to the rear porch.

REAR PORCH

A rear porch, ideal for storing coats and shoes, with access leading directly to the rear garden.

FIRST FLOOR

BEDROOM ONE

A good-sized bedroom offering fantastic views, plenty of space for freestanding furniture, and a central heating radiator.

BEDROOM TWO

Featuring a rear-facing double-glazed window and central heating radiator. A door leads to a staircase, which in turn provides access to the converted loft space.

BATHROOM

Fitted with a three-piece suite comprising a corner bath with shower over, WC, and wash hand basin. Includes a central heating radiator and a window with obscure glazing for privacy.

SECOND FLOOR

ATTIC ROOM

An occasional room, offering a versatile space—ideal for a home office, hobby room, guest area, or additional storage.

OUTSIDE

The property is set back from the main road, featuring a buffer-style front garden for added privacy. To the rear, there's an enclosed, low-maintenance garden with both decked and patio areas—perfect for outdoor relaxation and entertaining.

Additionally, the property benefits from two garages and off-road parking at the rear.

Area Map



Floor Plans

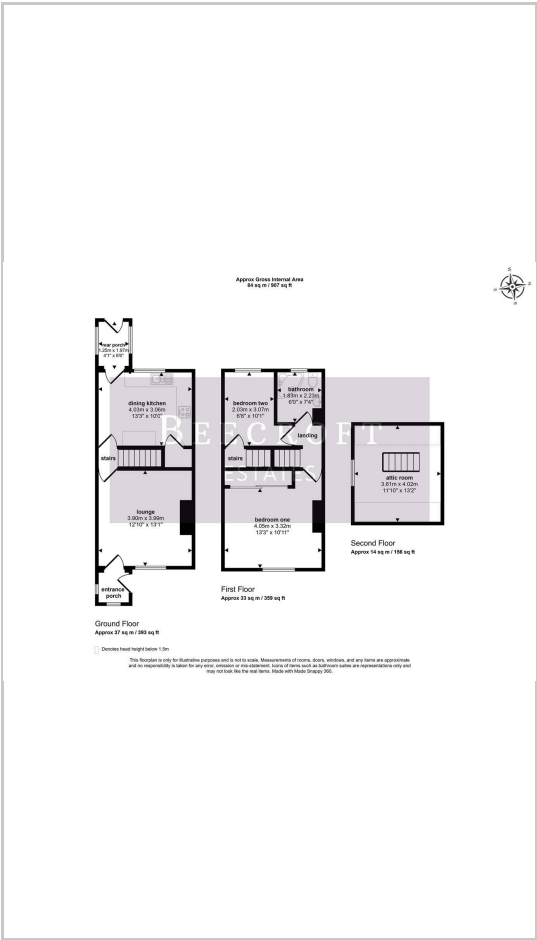

Energy Efficiency Graph

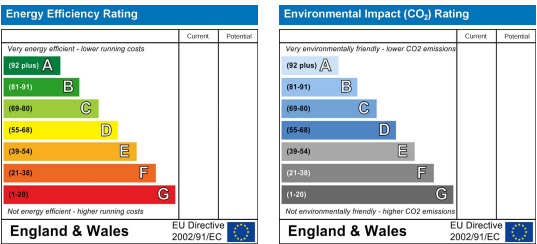

These particulars, whilst believed to be accurate are set out as a general outline only for guidance and do not constitute any part of an offer or contract. Intending purchasers should not rely on them as statements of representation of fact, but must satisfy themselves by inspection or otherwise as to their accuracy. No person in this firms employment has the authority to make or give any representation or warranty in respect of the property.