



126 Hough Lane

Wombwell, Barnsley, S73 0EF

£115,000



This two-bedroom mid-terrace house is ideally located close to local amenities, bus routes, and the train station. Perfect as a first-time buy or investment opportunity, the property offers a potential rental income of approximately £675 per calendar month and is ready for a tenant to move straight in!

CALL BEECROFT ESTATES TODAY TO BOOK YOUR VIEWING !



- GROUND FLOOR
- LOUNGE
- KITCHEN
- BATHROOM
- FIRST FLOOR
- BEDROOM ONE
- BEDROOM TWO
- OUTSIDE

Area Map



Floor Plans

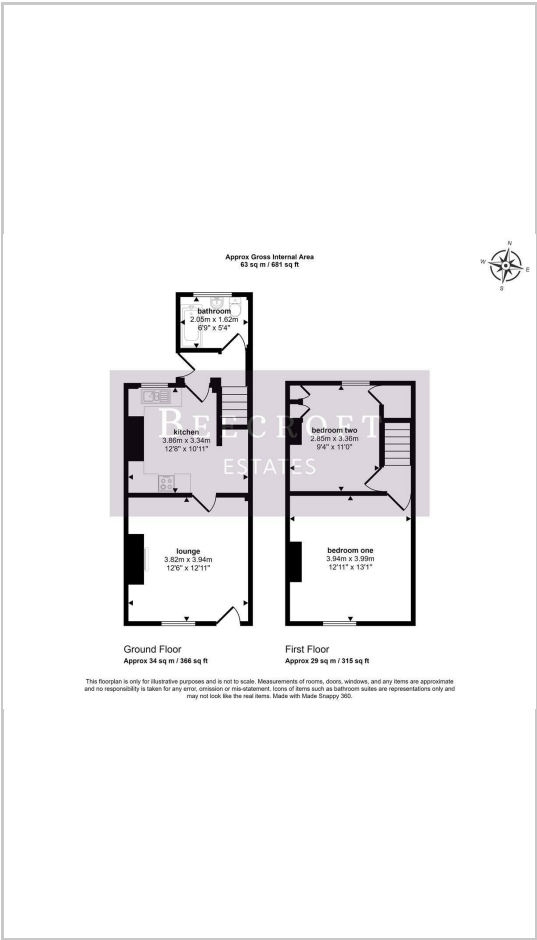

Energy Efficiency Graph

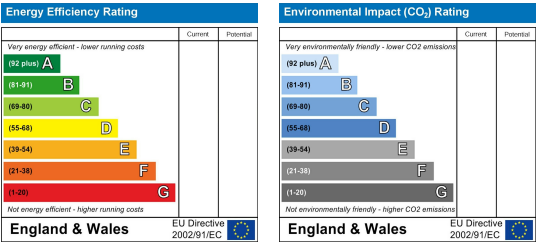

These particulars, whilst believed to be accurate are set out as a general outline only for guidance and do not constitute any part of an offer or contract. Intending purchasers should not rely on them as statements of representation of fact, but must satisfy themselves by inspection or otherwise as to their accuracy. No person in this firms employment has the authority to make or give any representation or warranty in respect of the property.