



## 35 Almond Croft

Wombwell, Barnsley, S73 0NL

£265,000



Offered with NO UPWARD CHAIN, this immaculate and modern three-bedroom semi-detached home is positioned at the end of a quiet cul-de-sac on the highly sought-after Wombwell Estate. Finished to an exceptional standard throughout, the property is truly move-in ready and ideal for buyers looking for a well-maintained home they can occupy straight away.

The accommodation is stylish, contemporary, and carefully presented, reflecting a high level of care and attention throughout. Externally, the property enjoys an enviable position with a double garage PLUS off-road parking for up to 3 cars, providing excellent practicality for families and visitors alike. Security is further enhanced by a professionally installed intruder alarm system and CCTV.

Perfectly located, the home is within a short walk of the train station and offers excellent access to the M1 motorway network, as well as Cortonwood Retail Park and a range of local amenities. Combining convenience, security, and modern living, this superb home represents an outstanding opportunity in a desirable residential setting.



## GROUND FLOOR

### ENTRANCE HALL

A side entrance door leads into the hallway, where stairs rise to the first-floor landing, providing access to the upper accommodation.

### LOUNGE

A beautifully presented and spacious lounge, elegantly decorated and offering a comfortable living space. The room benefits from French doors opening onto the rear garden, allowing for plenty of natural light and seamless indoor-outdoor flow. There is also a TV aerial point wood effect flooring.

### DINING KITCHEN

A beautiful and well-maintained dining kitchen is located at the front of the property and benefits from a bay-style double-glazed window, allowing plenty of natural light. The kitchen is fitted with a range of wall and base units with work surfaces over, incorporating a sink unit with mixer tap. Integrated appliances include double ovens, a five-ring gas hob with extractor hood above, and a dishwasher. There is also space for a fridge freezer and plumbing for a washing machine. The room offers ample space for a dining table, making it ideal for both everyday family meals and entertaining guests.

### DOWNSTAIRS WC

Comprising a low-level WC, wash hand basin, obscure double-glazed window, and radiator.

## FIRST FLOOR

### BEDROOM ONE

A good-sized bedroom with two front-facing double-glazed windows, fitted wardrobes, and a radiator.

### BEDROOM TWO

Having a rear-facing double-glazed window and radiator, with ample space for a bed and furniture.

### BEDROOM THREE

Having a rear-facing double-glazed window and radiator. Currently being utilised as a dressing space, this room offers ample space for bedroom furniture.

### HOUSE BATHROOM

A three-piece suite comprising a bath with shower over, WC and wash hand basin. The room is fully tiled and benefits from a double-glazed window with obscure glazing and a radiator.

## OUTSIDE

To the rear of the property is a detached double garage finished to a high specification, benefiting from LED lighting, an electric door, and a secure side access door. The garage provides excellent storage or workshop potential. There is also a designated area for relaxing and entertaining, complemented by attractive red granite stones, along with three parking spaces located to the front.

## Area Map



## Floor Plans

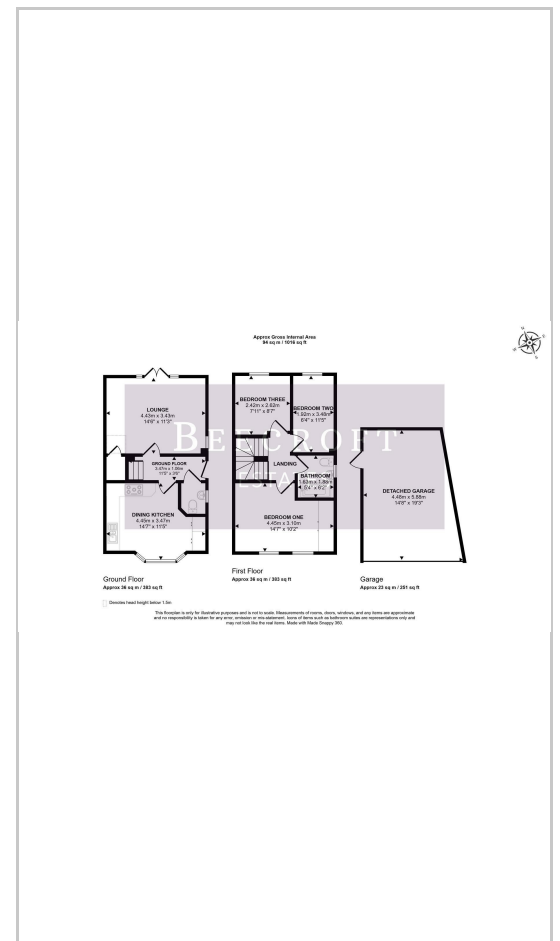

## Energy Efficiency Graph

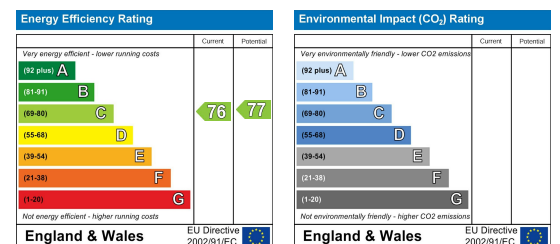

These particulars, whilst believed to be accurate are set out as a general outline only for guidance and do not constitute any part of an offer or contract. Intending purchasers should not rely on them as statements of representation of fact, but must satisfy themselves by inspection or otherwise as to their accuracy. No person in this firm's employment has the authority to make or give any representation or warranty in respect of the property.

Wombwell 6-8 Park Street, Wombwell, S73 0DJ

Tel: 01226 340110 Email: info@beecroftstates.co.uk www.beecroftstates.co.uk