

GROUND FLOOR  
APPROX. FLOOR  
AREA 339 SQ.FT.  
(31.5 SQ.M.)

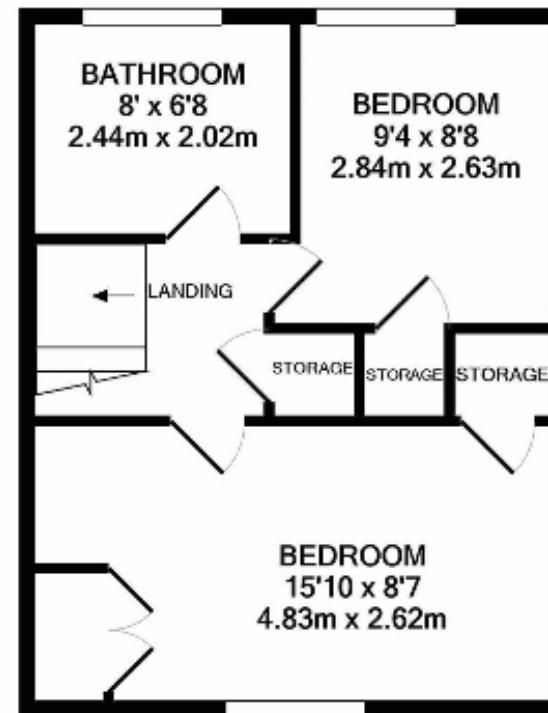

1ST FLOOR  
APPROX. FLOOR  
AREA 328 SQ.FT.  
(30.4 SQ.M.)

## DEAKIN CLOSE, WATFORD, WD18

APPROX, GROSS FLOOR AREA 667 SQ FT (62 SQ METRES)

Whilst every attempt has been made to ensure the floor plan contained here, measurements of doors, windows and rooms are approximate, and no responsibility is taken for any error, omission or misstatement. These plans are for representation purposes only as defines by RICS Code of Measuring Practice and should be used as such by any prospective purchaser. Specifically, no guarantee is given on the total square footage of the property is quoted on this plan. Any figure given is for initial guidance only and should not be relied on as a basis of evaluation. This floor plane was constructed using measurements provided to Tyrone Ash Real Estate by third a party.