



15, Portman Square,
, W1H

£2,200 Per Month,

NAPIER WATT

T: 0207 935 0011
E: enquiries@napierwatt.co.uk
W: napierwatt.co.uk

35 Berkeley Square, Mayfair, London, W1J 5BF







Description

Charming studio apartment in the this highly sought-after purpose-built development in Portman Square. The apartment of 289sq ft is set on the lower ground floor but has a light and airy feel from the good ceiling height and large windows. The property well proportioned and the kitchen has been updated to a very good standard. Residents of this apartment benefit from access to the communal garden square, 24-hour concierge service as well as heating and hot water being included in the rent. Available now, furnished.

Studio : 24-Hour Concierge : Lift : Communal Garden Square : Westminster Council Tax Band E : EPC Rating C

Key Features

- 24-HOUR CONCIERGE
- MODERN KITCHEN
- HEATING & HOT WATER INLCUDED
- PASSENGER LIFTS
- BIGHT & AIRY
- COMMUNAL GARDENS

Terms

Fees & Charges: Tenancies exceeding £100,000 Per annum £480 inc VAT, Tenancies where a company is a tenant £480 inc VAT

Portman Square

Approx. Gross Internal Area 289 Sq Ft - 26.85 Sq M

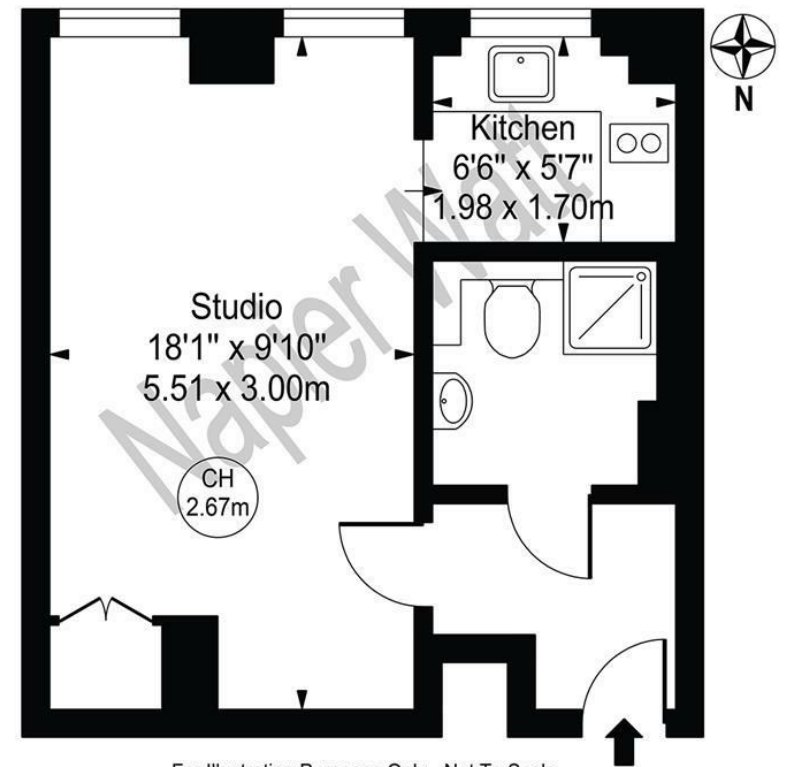

For Illustration Purposes Only - Not To Scale

This floor plan should be used as a general outline for guidance only and does not constitute in whole or in part an offer or contract. Any intending purchaser or lessee should satisfy themselves by inspection, searches, enquiries and full survey as to the correctness of each statement. Any areas, measurements or distances quoted are approximate and should not be used to value a property or be the basis of any sale or let.

IMPORTANT: We would inform prospective purchasers that these sales particulars have been prepared as a general guide only. A detailed survey has not been carried out, nor the services, appliances and fittings tested. Room sizes should not be relied upon for furnishing purposes and are approximate. If floor plans are included, they are for guidance only and illustration purposes only and may not be to scale. If there are any important matters likely to affect your decision to buy, please contact us before viewing the property.