



Bryanston Court, George Street,
Marylebone, W1H

£1,300 Per Week,

NAPIER WATT

T: 0207 935 0011
E: enquiries@napierwatt.co.uk
W: napierwatt.co.uk

35 Berkeley Square, Mayfair, London, W1J 5BF







Description

A lateral four bedroom family home, set in this highly sought-after portered block in Marylebone. Positioned on the fifth floor this apartment, of approximately 1,765sq ft, is one of the few in the building with a roof terrace. The property comprises a living room, dining room, kitchen, four bedrooms, three bathrooms, guest cloakroom, and a south-west facing balcony. The building boasts a 24-hour porter service, passenger lifts and is a short walk Marble Arch station and Hyde Park. Available, unfurnished. No HMO licence.

4 Bedrooms : 3 Bathrooms : Guest W.C. : Porter : Lift : Roof Terrace : Westminster Council Tax Band H : EPC Rating C

Key Features

- LATERAL THREE BED
- PASSENGER LIFT
- ROOF TERRACE
- NO HMO LICENCE
- HIGH CEILINGS
- 24-HOUR PORTER
- WOODEN FLOORING

Terms

Fees & Charges: Tenancies exceeding £100,000 Per annum £480 inc VAT, Tenancies where a company is a tenant £480 Inc VAT.

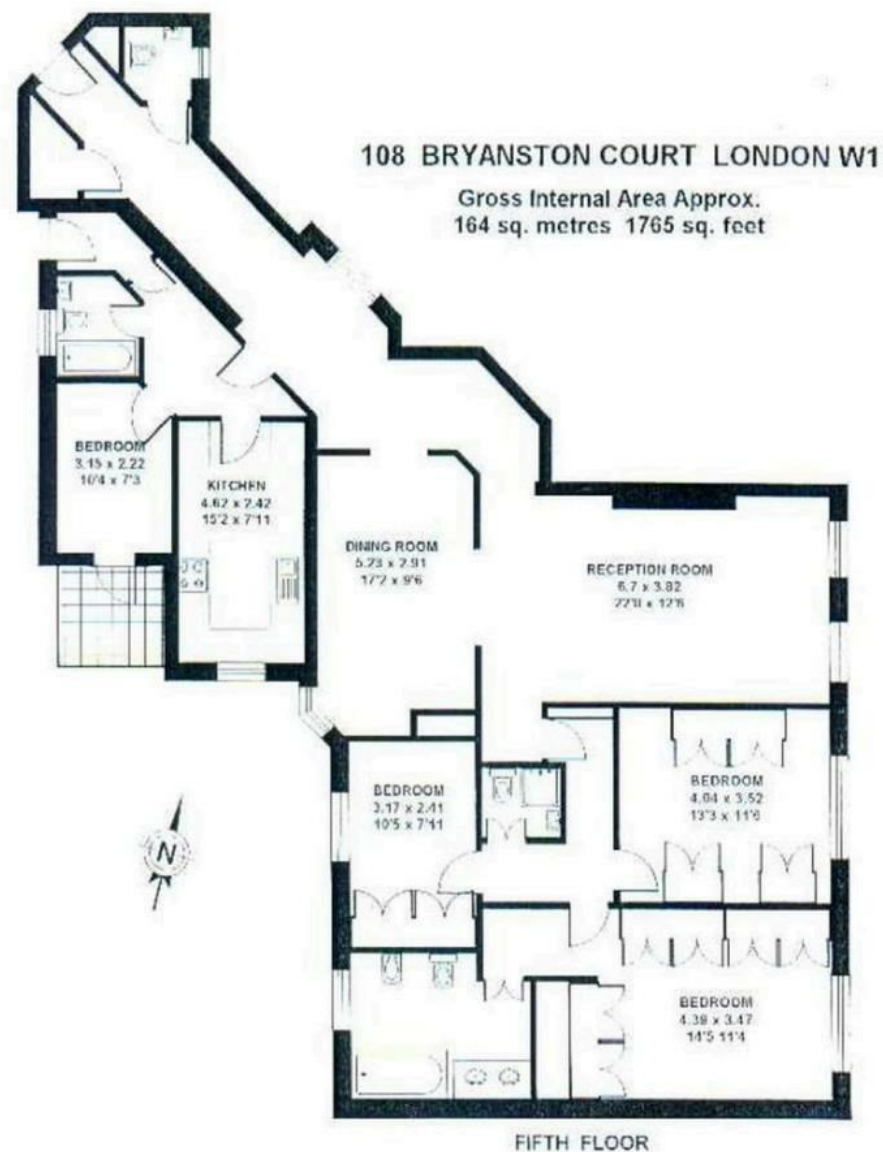

IMPORTANT: We would inform prospective purchasers that these sales particulars have been prepared as a general guide only. A detailed survey has not been carried out, nor the services, appliances and fittings tested. Room sizes should not be relied upon for furnishing purposes and are approximate. If floor plans are included, they are for guidance only and illustration purposes only and may not be to scale. If there are any important matters likely to affect your decision to buy, please contact us before viewing the property.