



Wilshire House 2 Prospect Way, Battersea, SW11

Guide Price £700,000, Leasehold

NAPIER WATT

T: 0207 935 0011

E: enquiries@napierwatt.co.uk

W: napierwatt.co.uk

35 Berkeley Square, Mayfair, London, W1J 5BF







Description

Napier Watt have pleasure in offering this one bedroom apartment designed by architect, Frank Gehry's as part of his first residential building in the UK.

Designed as an integral part of the iconic Battersea Power Station, Wilshire House, residents enjoy exclusive access to a range of first-class amenities, including a 24-hour concierge, an on-site gym, cinema, residents' lounge, meeting rooms, extensive landscaped communal gardens, resident's roof terrace.

This compact one bedroom, is set on the fifth floor and offer 681 sqft / 63 sqm of accommodation. Internally, it is exceptionally well presented and features mood lighting, comfort cooling, and heating controlled via display panels.

Reception Room : Open Plan Fitted Kitchen : Winter Garden : Double Bedrooms : Ensuite Bathrooms : Parking Available To Rent Subject To Availability: 24hr Concierge : Gym & Leisure Facilities : Cinema : Communal Roof Terrace : EPC Rating B

Key Features

- BY ORDER OF THE OFFICIAL RECEIVER
- PARKING TO RENT SUBJECT TO AVAILABILITY
- RIVERSIDE LOCATION
- LANDSCAPED COMMUNAL GARDENS
- ARCHITECTURE BY FRANK GEHRY
- 24 HOUR CONCIERGE
- LOCATED OPPOSITE ICONIC GRADE II* LISTED BUILDING
- COMFORT COOLING & MOOD LIGHTING

Terms

Leasehold : 12/12/3011 ie 987years

Service Charge : £8,304.27 pa

Ground Rent : £0 pa

EPC : B - Council Tax : Wandsworth Band F

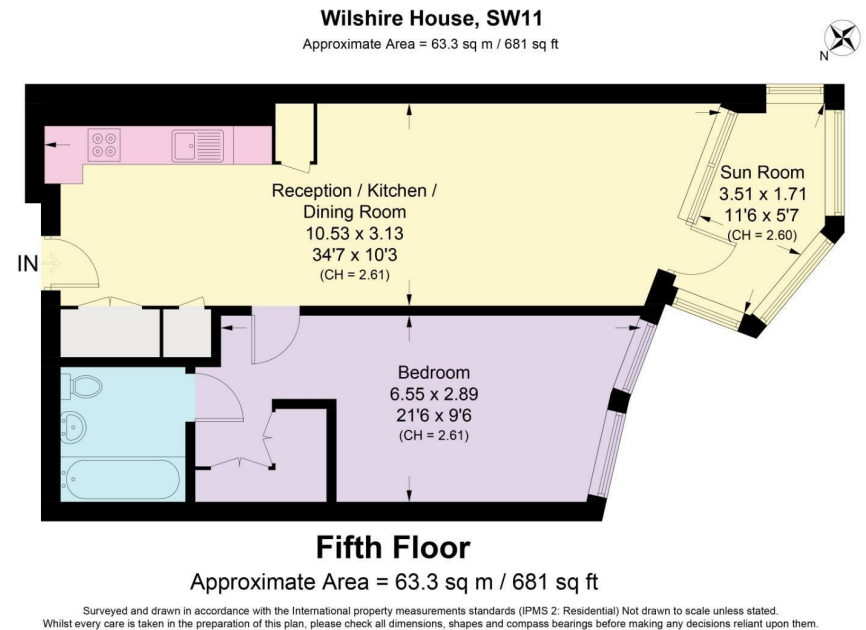

IMPORTANT: We would inform prospective purchasers that these sales particulars have been prepared as a general guide only. A detailed survey has not been carried out, nor the services, appliances and fittings tested. Room sizes should not be relied upon for furnishing purposes and are approximate. If floor plans are included, they are for guidance only and illustration purposes only and may not be to scale. If there are any important matters likely to affect your decision to buy, please contact us before viewing the property.