



Greenhaven Court, 1a Montagu Place,  
Marylebone, W1H

£4,766 Per Month,

NAPIER WATT

T: 0207 935 0011  
E: [enquiries@napierwatt.co.uk](mailto:enquiries@napierwatt.co.uk)  
W: [napierwatt.co.uk](http://napierwatt.co.uk)

35 Berkeley Square, Mayfair, London, W1J 5BF









## Description

An absolutely beautiful, fully refurbished two double bedroom, two bathroom fourth floor apartment set within this sought after portered building with a lift.

Greenhaven Court is located on the corner of Gloucester and Montagu Place, and benefits from a day porter, lift and excellent location offering easy access to Baker Street, Marylebone and Bond Street underground stations, with Marylebone Village being only a short walk away.

The apartment has just been fully refurbished and benefits from spacious, light and airy accommodation with some wood floors, newly fitted kitchen and bathrooms.

## Key Features

- DAY PORTER
- THIRD FLOOR
- FURNISHED OR UNFURNISHED
- NEW BATHROOMS
- PASSENGER LIFT
- NEWLY REFURBISHED
- SOME WOOD FLOORS
- NEW GAS CENTRAL HEATING

## Terms

**Fees & Charges:** Tenancies exceeding £100,000 Per annum £480 inc VAT, Tenancies where a company is a tenant £480 Inc VAT.

## Greenhaven Court

Approx. Gross Internal Area 891 Sq Ft - 82.78 Sq M

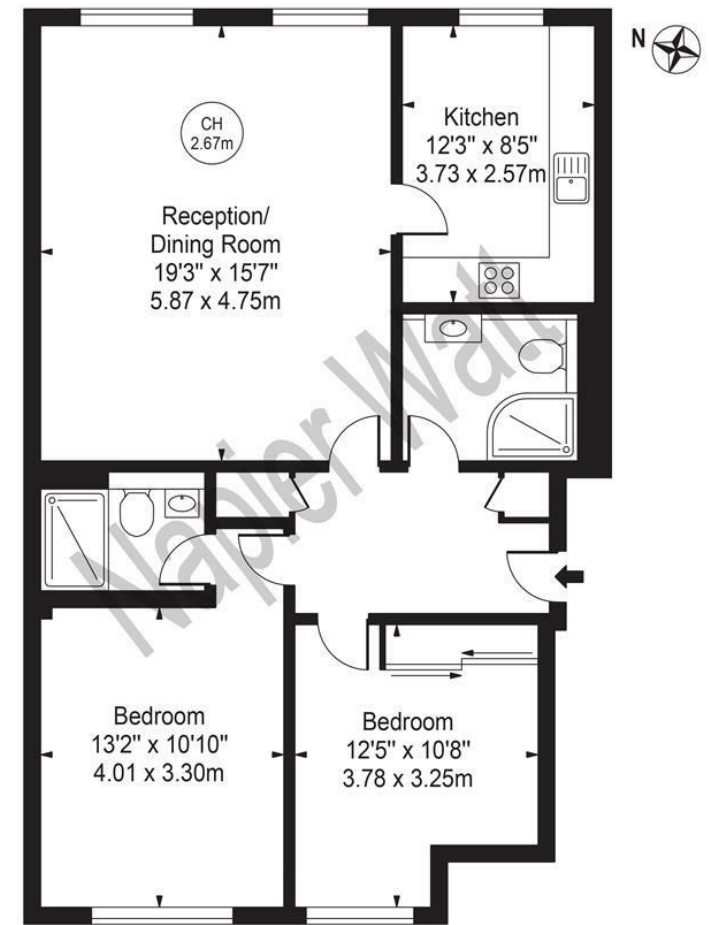

## Third Floor

For Illustration Purposes Only - Not To Scale

This floor plan should be used as a general outline for guidance only and does not constitute in whole or in part an offer or contract. Any intending purchaser or lessee should satisfy themselves by inspection, searches, enquiries and full survey as to the correctness of each statement. Any areas, measurements or distances quoted are approximate and should not be used to value a property or be the basis of any sale or let.

IMPORTANT: We would inform prospective purchasers that these sales particulars have been prepared as a general guide only. A detailed survey has not been carried out, nor the services, appliances and fittings tested. Room sizes should not be relied upon for furnishing purposes and are approximate. If floor plans are included, they are for guidance only and illustration purposes only and may not be to scale. If there are any important matters likely to affect your decision to buy, please contact us before viewing the property.