



The Phoenix, Bird Street,
Marylebone, W1U

£875 Per Week,

NAPIER WATT

T: 0207 935 0011
E: enquiries@napierwatt.co.uk
W: napierwatt.co.uk

35 Berkeley Square, Mayfair, London, W1J 5BF







Description

A 2 bedroom, 2 bathroom sixth floor apartment with lift and porter well located for Bond Street station and Oxford Street. The apartment further benefits from private underground parking. Bird Street is conveniently located for the many amenities, restaurants and shops offered by Oxford Street and the surrounding area. The closest Underground stations are Bond Street (Central and Jubilee lines), located 0.1 miles from the property and Oxford Circus (Bakerloo, Victoria and Central lines), located 0.4 miles from the property.

2 Bedrooms : En Suite Bathroom : Shower Room : Reception Room : Kitchen : Parking :
Lift : Porter : 2 Balconies : EPC Rating C

Key Features

- DAY PORTER
- LIFT
- SIXTH FLOOR
- FURNISHED
- AVAILABLE APRIL
- PARKING AVAILABLE SEP NEG
- BALCONY

Terms

Fees & Charges: Tenancies exceeding £100,000 Per annum £480 inc VAT, Tenancies where a company is a tenant £480 Inc VAT.

The Phoenix

Approx. Gross Internal Area 901 Sq Ft - 83.71 Sq M

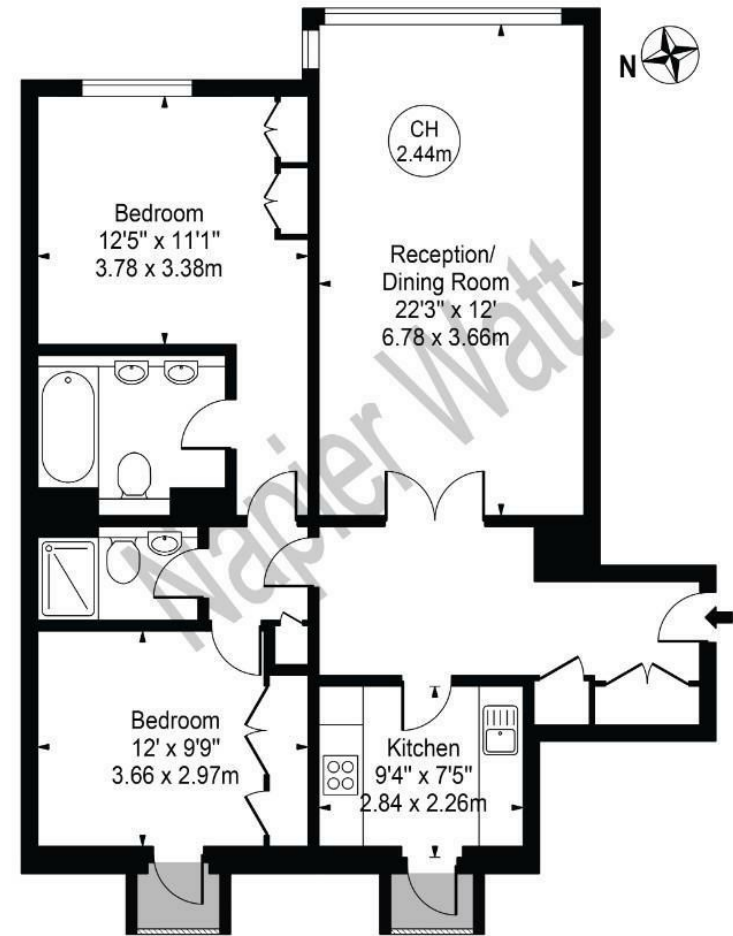

Sixth Floor
For Illustration Purposes Only - Not To Scale

This floor plan should be used as a general outline for guidance only and does not constitute in whole or in part an offer or contract. Any intending purchaser or lessee should satisfy themselves by inspection, searches, enquiries and full survey as to the correctness of each statement. Any areas, measurements or distances quoted are approximate and should not be used to value a property or be the basis of any sale or let.

IMPORTANT: We would inform prospective purchasers that these sales particulars have been prepared as a general guide only. A detailed survey has not been carried out, nor the services, appliances and fittings tested. Room sizes should not be relied upon for furnishing purposes and are approximate. If floor plans are included, they are for guidance only and illustration purposes only and may not be to scale. If there are any important matters likely to affect your decision to buy, please contact us before viewing the property.