



Chatsworth Court, Pembroke Road,
Kensington, W8

£575 Per Week,

NAPIER WATT

T: 0207 935 0011
E: enquiries@napierwatt.co.uk
W: napierwatt.co.uk

35 Berkeley Square, Mayfair, London, W1J 5BF







Description

An exceptionally spacious flat situated on the third floor (with lift) of this sought-after Art Deco building, ideally located within a short walk of both High Street Kensington and Earl's Court Underground stations (Piccadilly and District lines). The property boasts a recently fitted modern kitchen and shower room, double-glazed windows throughout, and excellent storage. Residents benefit from 24-hour portering and extensive communal gardens, offering both convenience and a sense of community.

1 Bedroom : 1 Bathroom : 24-Hour Porter : EPC Rating C : Kensington & Chelsea Council Tax Band E

Key Features

- THIRD FLOOR WITH LIFT
- 24 HOUR PORTERAGE
- EXTENSIVE COMMUNAL GARDENS
- SECONDARY GLAZED
- ART DECO BUILDING

Terms

Additional costs will apply for; referencing (£36 per person & guarantor); administration (£240); renewal/extensions (£120); check-out inventory & cleaning (variable); special requests (variable). Security Deposits also apply to all tenancies.

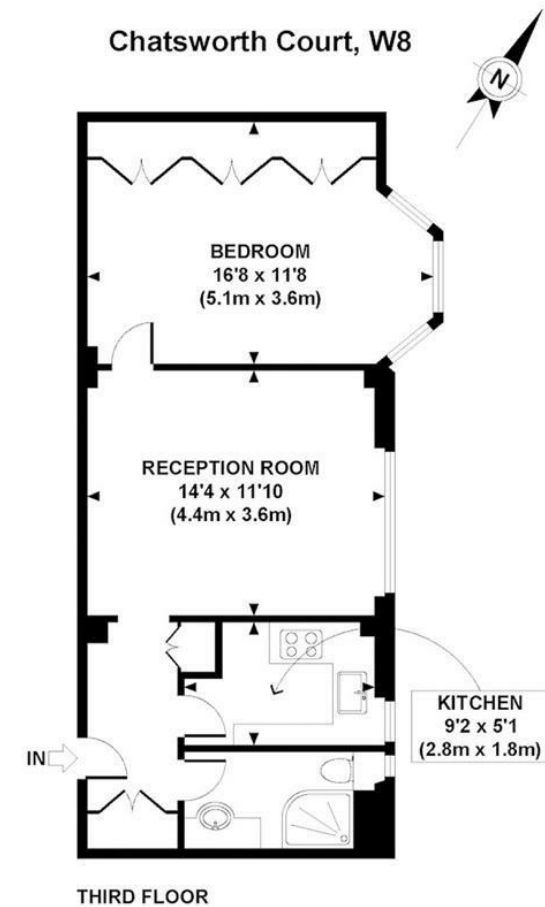

APPROX. GROSS INTERNAL FLOOR AREA 508 SQ FT / 47.2 SQ M

IMPORTANT: We would inform prospective purchasers that these sales particulars have been prepared as a general guide only. A detailed survey has not been carried out, nor the services, appliances and fittings tested. Room sizes should not be relied upon for furnishing purposes and are approximate. If floor plans are included, they are for guidance only and illustration purposes only and may not be to scale. If there are any important matters likely to affect your decision to buy, please contact us before viewing the property.