



4, Connaught Place,
Marble Arch, W2

£550 Per Week,

NAPIER WATT

T: 0207 935 0011
E: enquiries@napierwatt.co.uk
W: napierwatt.co.uk

35 Berkeley Square, Mayfair, London, W1J 5BF







Description

Sole agents Napier Watt are pleased to offer for long let, this well-appointed and arranged one bedroom apartment set within a recently refurbished and converted white stucco fronted building. The property is fantastically located, a stone's throw from Marble Arch, Hyde Park and Oxford Street, not to mention Connaught and Portman Villages. This lower ground floor apartment offers 547sq ft / 51sq m of accommodation and consists of an entrance hall, living room with open plan kitchen, double bedroom, lovely bathroom with separate shower. Unusually this property has the benefit of a lift, grand communal areas and a secure bicycle storage area.
Available now, furnished.

1 Bedroom : 1 Bathroom : AC : Lift : Stucco-Fronted : Westminster Council Tax Band E : EPC Rating D

Key Features

- GRAND HOUSE
- LIFT
- AVAILABLE NOW
- 100M MARBLE ARCH
- VACANT

Terms

Fees & Charges: Tenancies exceeding £100,000 Per annum £480 inc VAT, Tenancies where a company is a tenant £480 Inc VAT.

Connaught Place

Approx. Gross Internal Area 547 Sq Ft - 50.82 Sq M

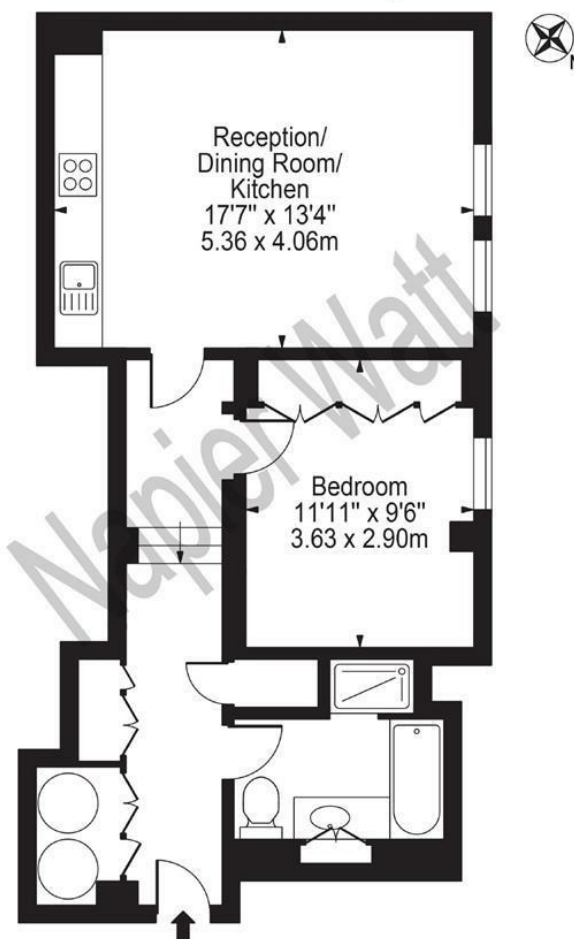

Lower Ground Floor
For Illustration Purposes Only - Not To Scale

This floor plan should be used as a general outline for guidance only and does not constitute in whole or in part an offer or contract. Any intending purchaser or lessee should satisfy themselves by inspection, searches, enquiries and full survey as to the correctness of each statement. Any areas, measurements or distances quoted are approximate and should not be used to value a property or be the basis of any sale or let.

IMPORTANT: We would inform prospective purchasers that these sales particulars have been prepared as a general guide only. A detailed survey has not been carried out, nor the services, appliances and fittings tested. Room sizes should not be relied upon for furnishing purposes and are approximate. If floor plans are included, they are for guidance only and illustration purposes only and may not be to scale. If there are any important matters likely to affect your decision to buy, please contact us before viewing the property.