



21-22, Prince Of Wales Terrace,
, W8

£3,865 Per Week,

NAPIER WATT

T: 0207 935 0011
E: enquiries@napierwatt.co.uk
W: napierwatt.co.uk

35 Berkeley Square, Mayfair, London, W1J 5BF

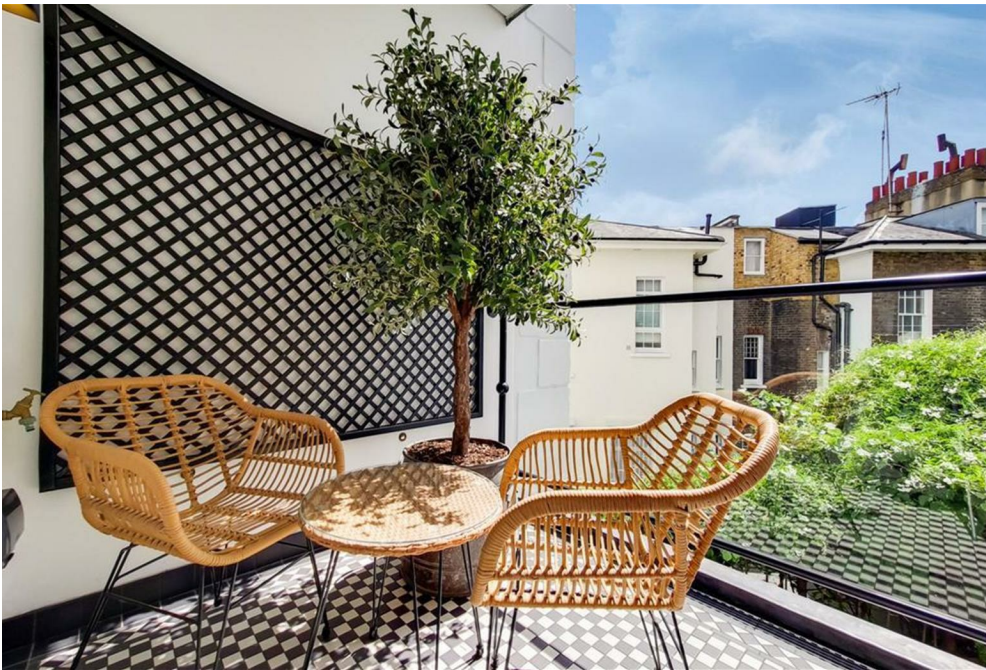





Description

Set across 1,266sq ft on the first floor of the building, this apartment is spacious and well-laid-out. The reception room features an ornate working fireplace, high ceilings, and a set of triple full-height doors leading to the large front-facing balcony. The dual-aspect master bedroom has a range of built-in wardrobes, an ensuite bathroom with underfloor heating, mirror-fronted cabinet units with integrated demister, and a door leading to the private courtyard terrace. The first bedroom also has an adjacent dressing room with dual aspect doors leading out to the rear terrace.

On-street parking is available via paid permit.

EPC rating: C

Council Tax band: G

Key Features

- PORTER
- VIDEO ENTRY
- WIFI
- SAMSUNG TVs
- CCTV
- AIR CONDITIONING
- DOUBLE GLAZING
- ALEXA VOICE-CONTROLLED UNITS

Terms

Fees & Charges: Tenancies exceeding £100,000 Per annum £480 inc VAT, Tenancies where a company is a tenant £480 Inc VAT.



FIRST FLOOR

APPROX. GROSS INTERNAL AREA *
1115 Ft² - 103.58 M²

IMPORTANT: We would inform prospective purchasers that these sales particulars have been prepared as a general guide only. A detailed survey has not been carried out, nor the services, appliances and fittings tested. Room sizes should not be relied upon for furnishing purposes and are approximate. If floor plans are included, they are for guidance only and illustration purposes only and may not be to scale. If there are any important matters likely to affect your decision to buy, please contact us before viewing the property.