



55, Ebury Street,
Belgravia, SW1W

£1,550 Per Week,

NAPIER WATT

T: 0207 935 0011
E: enquiries@napierwatt.co.uk
W: napierwatt.co.uk

35 Berkeley Square, Mayfair, London, W1J 5BF







Description

We're pleased to offer this beautifully presented three-bedroom apartment on the second floor of this fantastic portered building in the heart of Belgravia. The property of approximately 1,314sq ft has been finished to a very high standard and comprises three bedrooms, two bathrooms, modern fitted kitchen and a large living room that leads out to private balcony. This secure building benefits from 24-hour concierge and a lift. Surrounded by the various green spaces of Belgravia, the property is also moments from all the transport links, shop and restaurants of Victoria.

Available, furnished or part furnished.

3 Bedrooms : 2 Bathrooms : 24-Hour Concierge : Passenger Lift : Westminster Council Tax Band H : EPC Rating C

Key Features

- 24 HOUR PORTER
- PASSENGER LIFT
- BALCONY
- MODERN DESIGN
- SECURE DEVELOPMENT
- MOMENTS FROM VICTORIA

Terms

Fees & Charges: Tenancies exceeding £100,000 Per annum £480 inc VAT, Tenancies where a company is a tenant £480 Inc VAT.

Ebury Street

Approx. Gross Internal Area 1352 Sq Ft - 125.60 Sq M

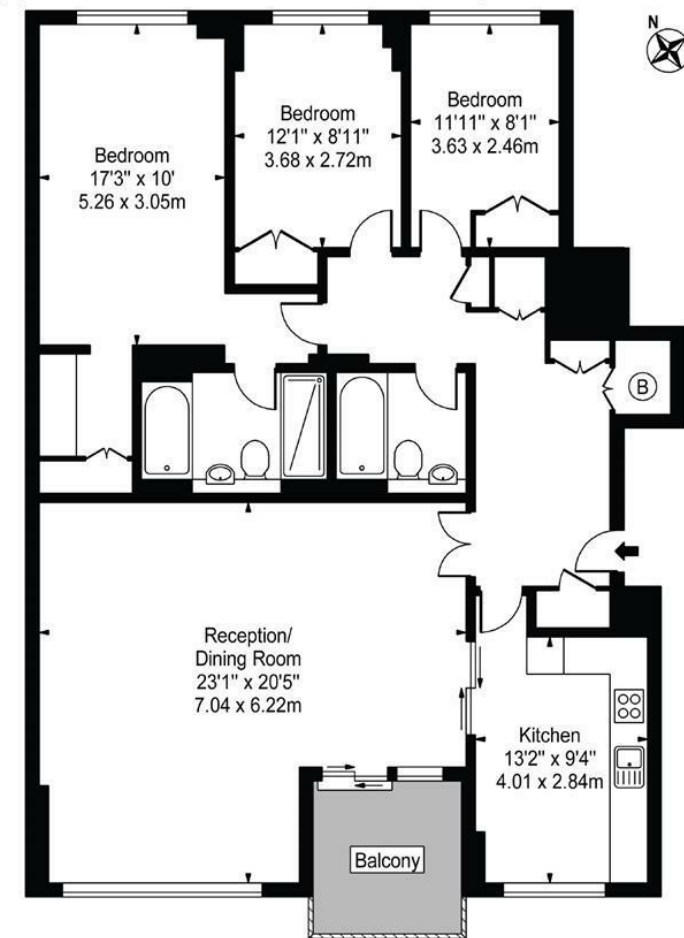

Second Floor

For Illustration Purposes Only - Not To Scale

This floor plan should be used as a general outline for guidance only and does not constitute in whole or in part an offer or contract. Any intending purchaser or lessee should satisfy themselves by inspection, searches, enquiries and full survey as to the correctness of each statement. Any areas, measurements or distances quoted are approximate and should not be used to value a property or be the basis of any sale or let.

IMPORTANT: We would inform prospective purchasers that these sales particulars have been prepared as a general guide only. A detailed survey has not been carried out, nor the services, appliances and fittings tested. Room sizes should not be relied upon for furnishing purposes and are approximate. If floor plans are included, they are for guidance only and illustration purposes only and may not be to scale. If there are any important matters likely to affect your decision to buy, please contact us before viewing the property.