

## Oak Village, Gospel Oak, NW5 4QP

**Asking Price £1,625,000**

A beautifully presented three bedroom cottage, enviably located within the tranquil setting of Oak Village. The present owners have designed the property throughout, with meticulous care and attention to detail in every room. The ground floor offers a double reception, leading to a large dining room and a fully fitted open-plan kitchen, which is very bright, benefiting from two Velux windows and double concertina doors opening to the charming rear garden. Three bedrooms are found on the first floor, along with a family bathroom and separate en-suite shower room. With just over 1400 square feet of space the house provides ample room for the growing family, in a wonderful location just a short walking distance from Hampstead Heath.

THREE DOUBLE BEDROOMS \* DOUBLE RECEPTION ROOM \* LARGE KITCHEN/DINING ROOM \* BATHROOM  
 \*EN-SUITE SHOWER ROOM \* GUEST CLOAKROOM\* ATTRACTIVE FRONT & REAR GARDENS \* FREEHOLD  
 \* RESIDENTS PERMIT PARKING \* COUNCIL TAX BAND G \* EPC C \*



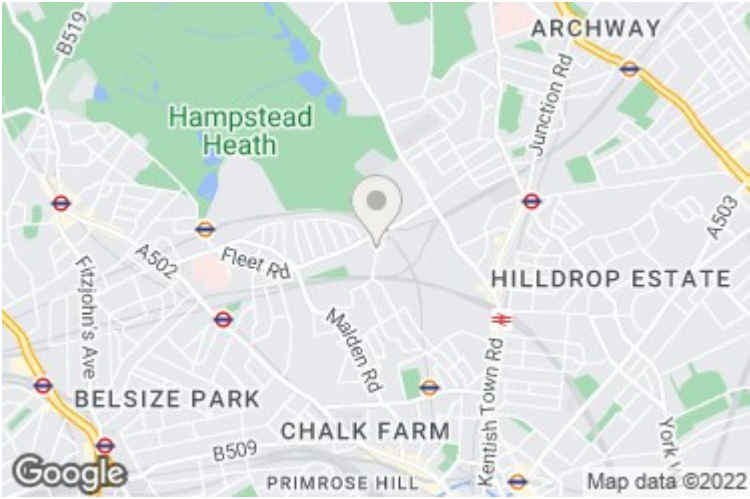



Ground Floor  
Area: 82.1 m<sup>2</sup> ... 884 ft<sup>2</sup>

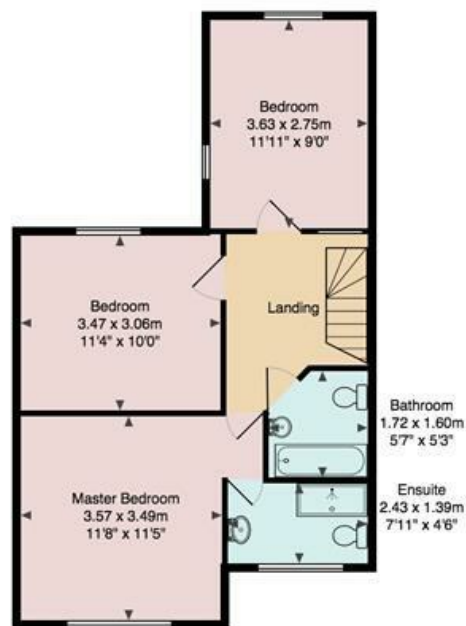

First Floor  
Area: 48.3 m<sup>2</sup> ... 520 ft<sup>2</sup>

Total Area: 130.4 m<sup>2</sup> ... 1404 ft<sup>2</sup>

Dimensions are approximate for display purposes only. (c) Peninsula Surveys Ltd.

## Oak Village NW5

